

# GAURA RIVERSIDE FARMS



OFFICE



ARIEL VIEW OF FARMS

## SALIENT FEATURES :-

- \*LOCATED NEAR CHANDRIKA DEVI TEMPLE
- \*COMMERCIAL, RESIDENTIAL AND ECO-FRIENDLY FARM HOUSES
- \*JOGGING TRACK ALONG THE RIVER SIDE
- \*LANDSCAPE GARDEN AND SITTING AREA
- \*PERGOLA AND GAZIBO SITTING AREA
- \*SUN DECK AND FOUNTAIN
- \*GYMNASIUM, SWIMMING POOL, YOGA AND CHILDREN PLAYING AREA.
- \*24X7 SECURITY

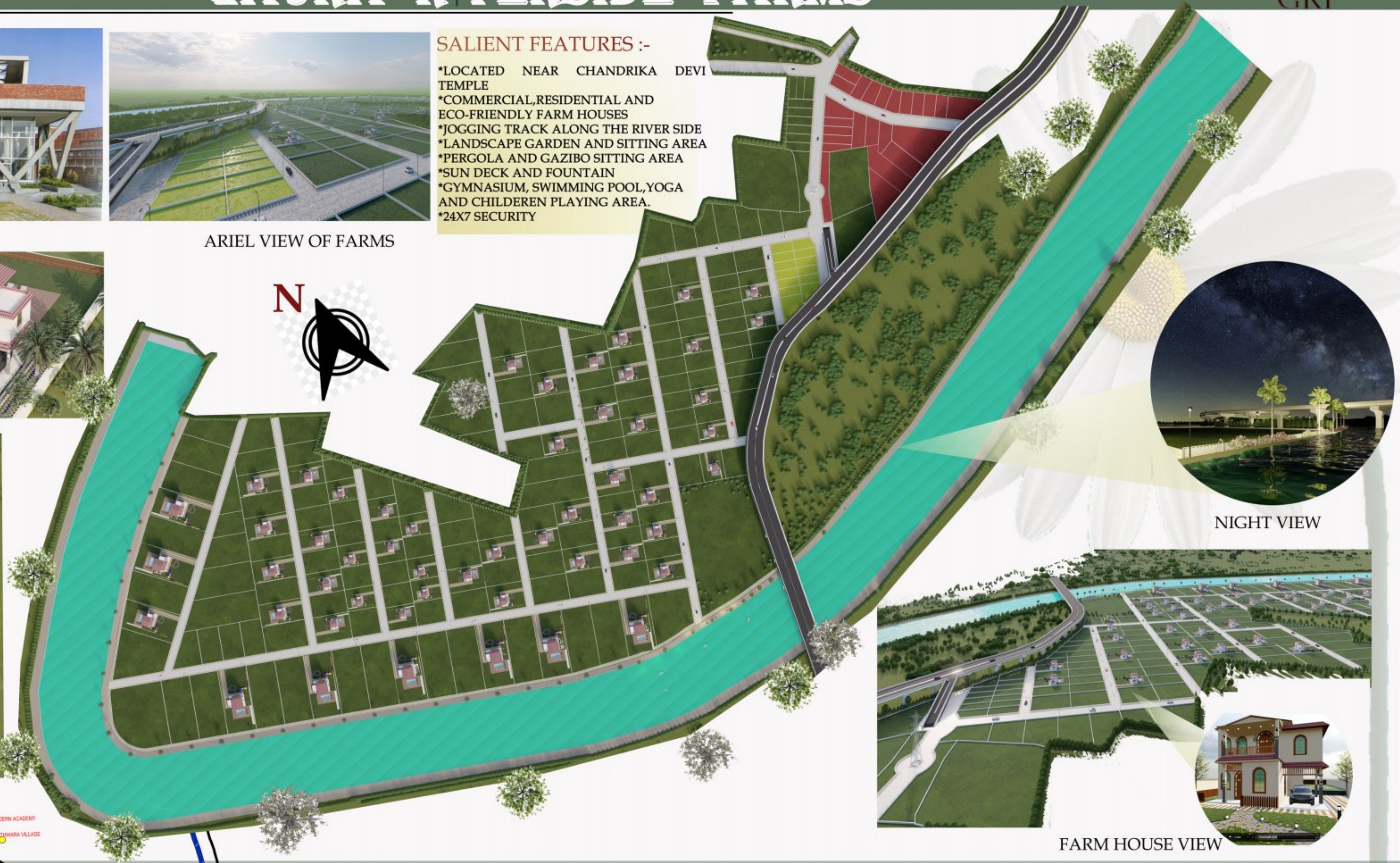

NIGHT VIEW



FARM HOUSE VIEW



## KEY DISTANCES:-

3 KM FROM KISAN PATH  
10 KM FROM NH 24

## PROJECT ADDRESS :-

NEAR MAA CHANDRIKA DEVI MANDIR  
BAKSHI KA TALAB, LUCKNOW

CONTACT:- 7905086411, 7388199993, 8299754224, 9554446070

## ARCHITECT :-

NIRVANA CONSULTANTS & ENGINEERS  
Ar.VISHAL JAIN